

# SKETCH/AREA TABLE ADDENDUM

Case No 13387

File No 01

SUBJECT

Property Address <b>800 Fitzgerald Drive</b>			
City <b>Wilmington</b>	County <b>New Hanover</b>	State <b>NC</b>	Zip <b>28405</b>
Borrower <b>Measured 1/05/21</b>			
Lender/Client <b>Melanie Cameron</b>	L/C Address <b>Coldwell Banker Sea Coast Realty</b>		
Appraiser Name <b>Jeremy Brant</b>	Appr Address <b>Home Dimensional</b>		

IMPROVEMENTS SKETCH

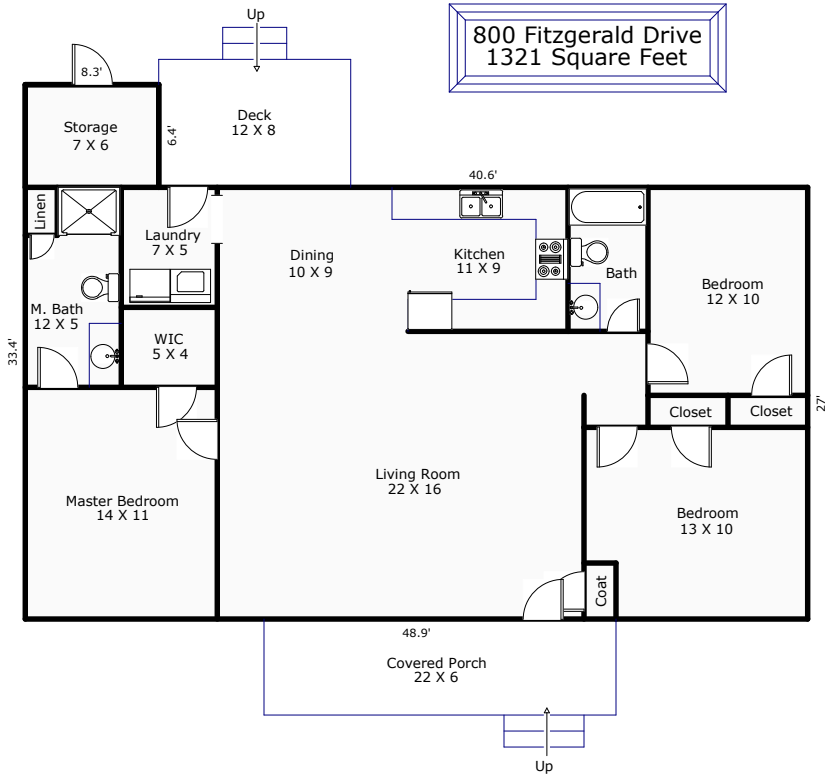

Comments: \*Home Dimensional is a professional measuring service, not a licensed appraisal company.

AREA CALCULATIONS

Scale: 1" = 12'

AREA CALCULATIONS SUMMARY			
Code	Description	Net Size	Net Totals
GLA1	First Floor	1320.75	1320.75
Net LIVABLE Area		(rounded)	1321

LIVING AREA BREAKDOWN			
Breakdown		Subtotals	
First Floor			
	48.9 x 27.0		1320.75
	6.4 x 8.3		53.47
Exterior Storage			-53.47
2 Items	(rounded)		1321